

Champion Belt

Portable personal training

USER MANUAL

4

4 channel exercise mode

Muscle strength / Aerobic / Massage /
Super training



Semi-permanent usage

Use semi-permanent with advanced silver
pad (not gel pad)



Easy operation

Button operation makes it easy for people of
all ages and sexes

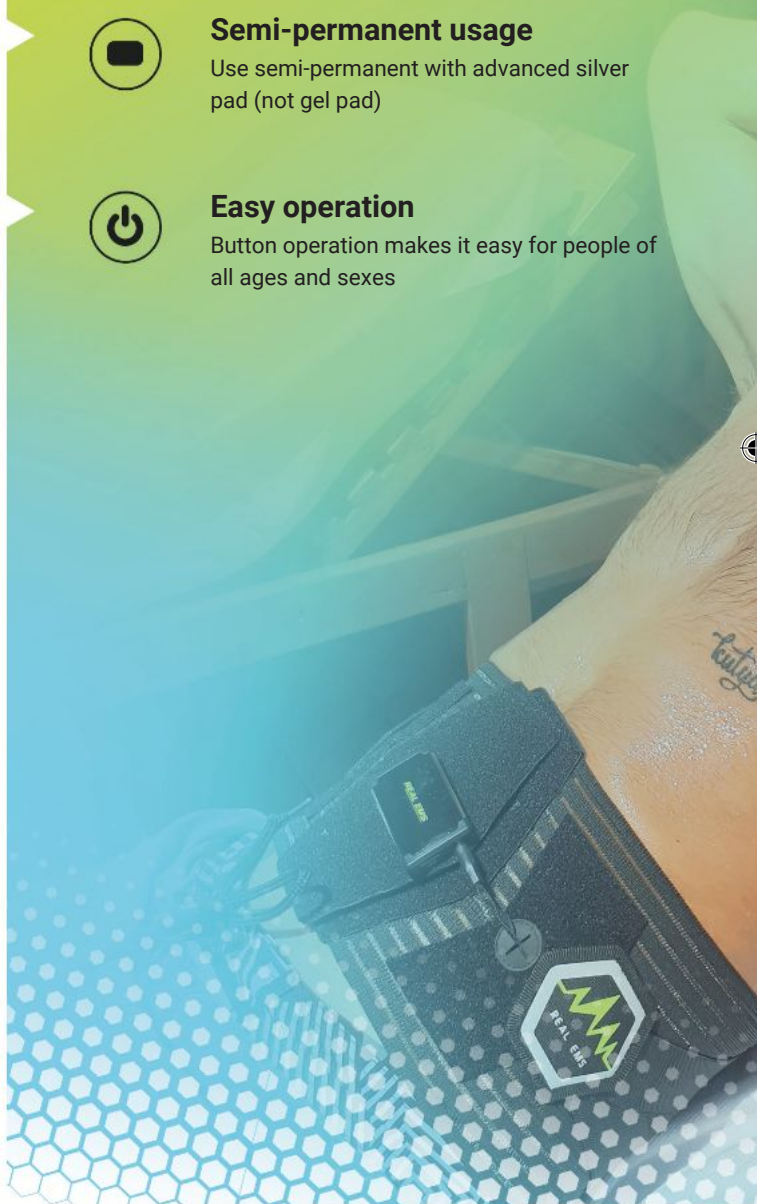

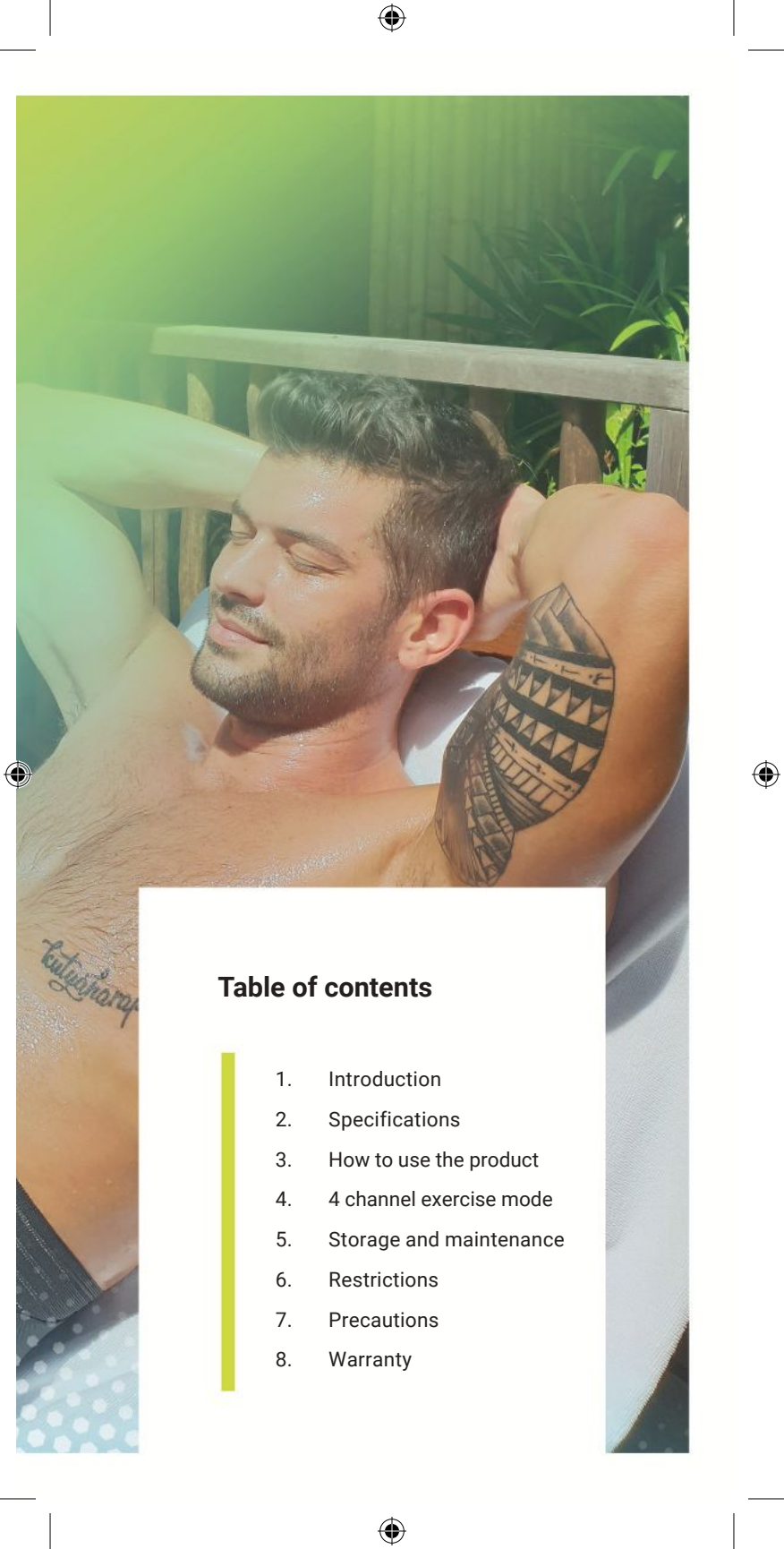

Table of contents

1. Introduction
2. Specifications
3. How to use the product
4. 4 channel exercise mode
5. Storage and maintenance
6. Restrictions
7. Precautions
8. Warranty

Introduction

▶ Purpose of use

The purpose of this product is to achieve the maximum possible training effect through electrical stimulation. (This product is not a medical device.)

▶ Reminder

Please read this manual thoroughly before using the product. The product cannot be used for children or animals.

Precautions

Do not randomly disassemble the product; the product will immediately stop after such disassembly, and it will not be covered by the warranty.

Specifications



► Specification

Product name	CHAMPION BELT
Model name	REAL EMS
Size (Unit : inch)	S: 25 ~ 28 / M: 29 ~ 33 / L:34 ~ 38 / XL: 39 ~ 43
Electrical specification	Electric Safety Authentication no.: P-REM-Ems-REAL EMS Rated power input: 3 VOLT Rated power output: 50 VOLT (Pk Max 100 MicroS) Power Consumption: Max 75mW

How to use the product

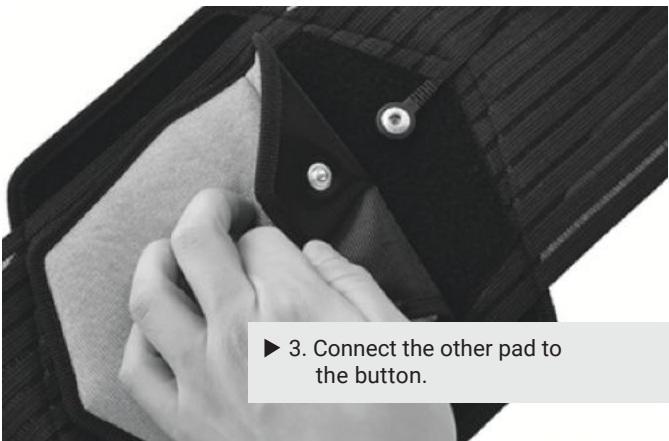
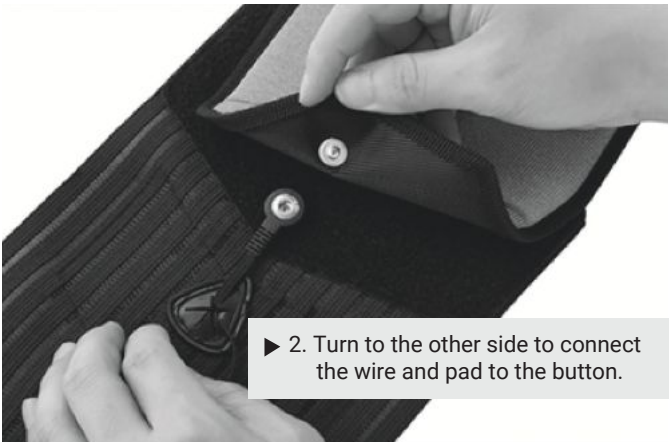
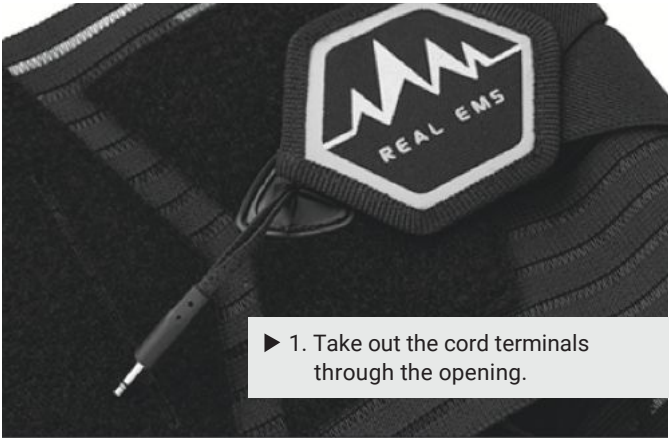



How to use the product



- Step 3. Make sure the pads are wet enough. Adjust the belt position so that the pads are tight on the back and abdomen; pads are detachable, so it is possible to attach the pads according to the user's needs.



It is recommended to put on the belt with the auxiliary belts detached; the belt does not stretch enough if the auxiliary belts are attached to the belt.

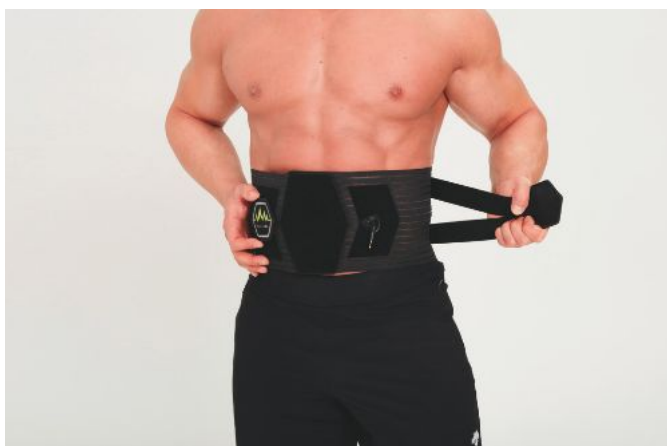

- ▶ Step 4. If the pads are tight on the back and abdomen, use the velcro to adjust the belt to the waist. It is recommended to tighten the belt enough so the user would feel a bit of pressure upon the waist. The auxiliary belts can be used to adjust the level of pressure/ tighten the belts.

How to use the product



- ▶ Step 5. Connect the controller to the cable after wearing the belt. Press and hold "ON" button to turn on the controller.

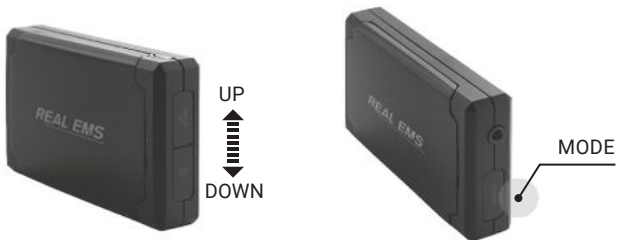

- ▶ Step 6. You can adjust the intensity (12 steps) by using "UP/DOWN" button on the micro controller and select the mode by using "MODE" button.

Charging part



- Step 7. After the use, the micro controller can be charged with a micro 5-pin charging terminal.

ON/UP

OFF/DOWN

REAL EMS

Charge

Connection

MODE



4Channel exercise mode

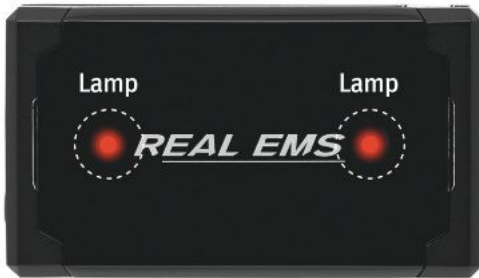

- ▶ **Red Light - With the muscle strength training program**
With the muscle strength training program is possible to have the desired effect without lifting any weight.

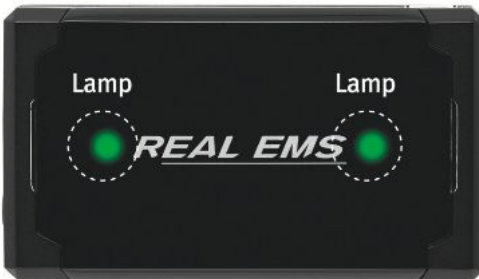

- ▶ **Green Light - Massage**
Massage program helps muscle relax with stimulation and relieves muscle from fatigue and tension.



► **Blue Light - Aerobic exercise program**

sends stimulation similar to actual aerobic exercise to the muscle; thereby enhancing the effectiveness of training in result.

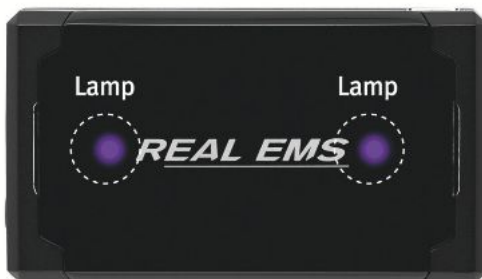

► **Purple Light - AUTO**

The program runs automatically for 20 minutes, switching between muscle strength, aerobic and massage programs.

Storage & Maintenance

► Storage of product

- Please keep the product at appropriate temperature and place.
- Avoid hot and humid places, keep the product away from children, pets or flammables.
- Make sure the microcontroller is always put in a safe place.

► Maintenance



- Please remove the controller and the pads when washing the product.
- Do not put the product in the washing machine, wash the product with lukewarm water.
- Do not twist belts or pads to squeeze water out.
- Do not use bleach.
- Do not dry-clean.
- Dry the product naturally in a flat place and check it is completely dry before use.
- Do not iron.

Restrictions

Please do not use the product if using the following medical electronic device.

- Inserted medical electronic devices such as artificial pacemakers
- Electronic appliances for life support, such as artificial heart
- Medical electronics such as electrocardiographs

The use is limited if the user has:

- Cardiac disease holder
- Pregnant women and women immediately after birth

Never use in the following areas:



- face, heart, tattoo and reproductive organs
- parts inserted into the body such as electrons, metals, silicon and plastic
- Abdominal area during menstrual period

Use the product after consulting a doctor in the following cases:

- Allergy (Anyone who has allergic reactions to the product or has an itch)
- recently operated on
- Anyone with bone problems such as osteoporosis
- High fever patients, acute disease, severe diseases, and abnormal blood pressure



Precatutions

- Make sure the pads are **tight against the skin** before using the product.
 - Do not drop or apply excessive force. This can **cause damage**.
 - Do not **randomly disassemble, modify or repair** the product.
 - Use of this product is restricted for those who **do not understand the user guideline and children**.
 - Contact the headquarters for **any faults or malfunctions**.
 - Do not use it on the **same area continuously for a long time**. The **proper usage time** for the product is **20 minutes**.
 - If you **feel pain or discomfort** during or after use, or if you **experience rash, itch, burns or inflammation**, **stop using it immediately** and consult your doctor.
- 
- 

Warranty

The warranty period is for **six months**. For defects of the product which are not the user's fault, within six months of the purchase the warranty will cover it.

This product is not covered by warranty if it has been repaired outside of the official service center or if it has been randomly disassembled/modified, or if you have used non-genuine parts.

For warranty, you must keep the product serial number sticker attached to the product box.

SERIAL NO.



Keep the serial stickers on the side of the box of warranty.



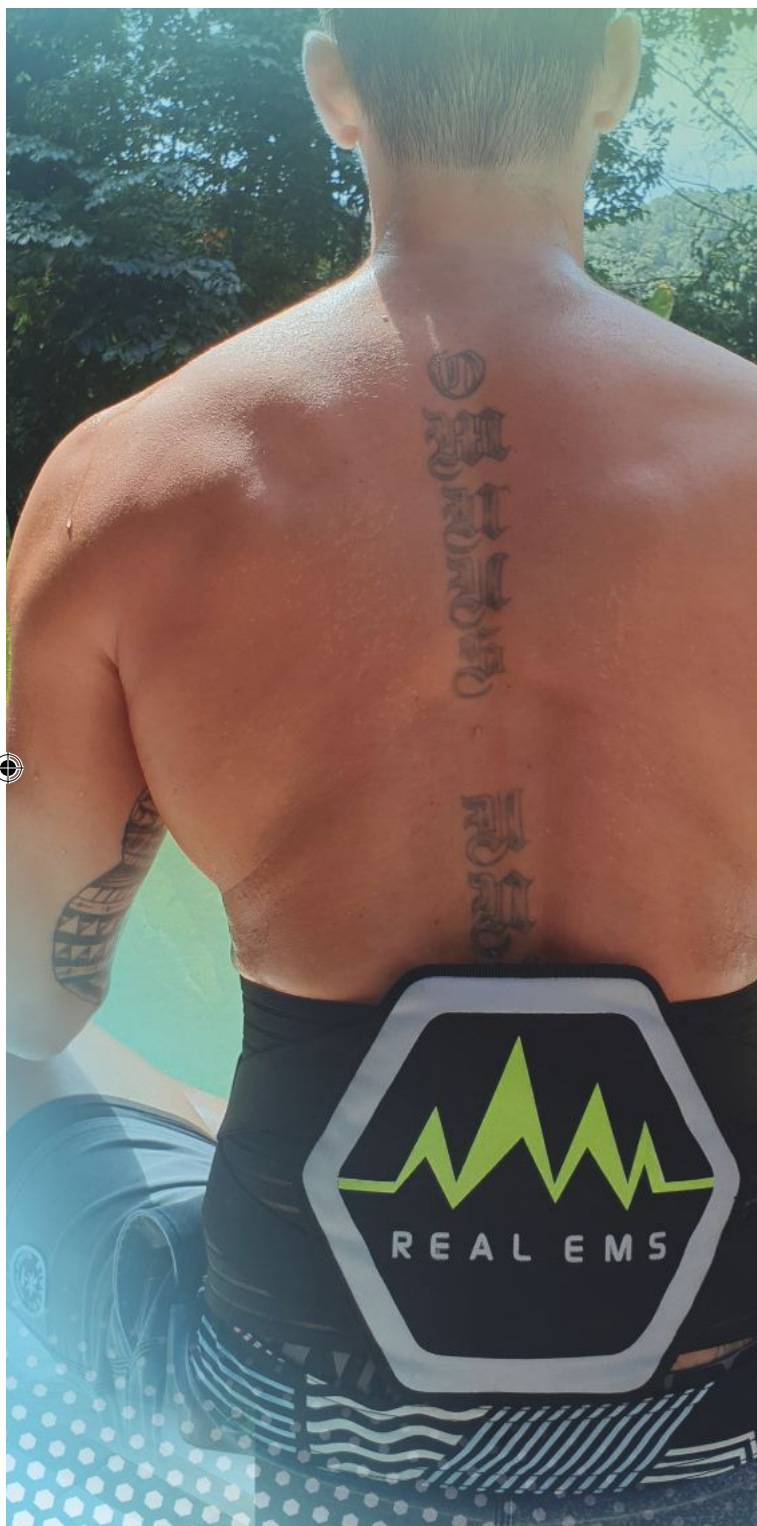



www.justfitart.com
sayhello@justfitart.com
+36 70 666 99 88